

REF NO :

LOCATION DETAILS OF THE PROJECT OF LAND DEMARCATED FOR THE PROJECT DEVELOPMENT ALONG WITH ITS BOUNDARIES INCLUDING THE LATITUDE & LONGITUDE OF THE ENDPOINT OF THE PROJECT

**PROJECT:** REVISED BASEMENT + GROUND + 9 STORIED RESIDENTIAL CUM COMMERCIAL BUILDING.

**NAME OF OWNERS:** KANCHANJUNGA BUILDERS LLP REPRESENTED BY ONE OF ITS PARTNERS - SRI. DIPAK MUNDHRA S/O. SRI. BIJAY KUMAR MUNDHRA

**LOCATION:** DAGABARI, JALPAIGURI

**LAND SCHEDULE:-**

- MOUZA - KHARIA
- PARGANA - BAKUNTHAPUR
- J.L. NO. - 07
- SHEET NO. - 23 L.R. & R.S.
- PLOT NO. - 242, 243, 244, 245 & 246 (R.S.)  
- 293, 295, 296, 297 & 298 (L.R.)
- KHATAN NO. - 2829, 17138, 2926, 2825, & 6386 (R.S.) 1699 (L.R.)
- WARD NO. - 17 (JALPAIGURI MUNICIPALITY)
- P.S. - KOTWALI
- DIST. - JALPAIGURI

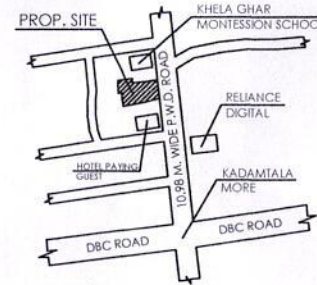

LOCATION PLAN  
SCALE- N.T.S.

*R. Biswas.*  
**RIYA BISWAS (B.Arch)**  
CA/2019/112919

SIGNATURE OF ARCHITECT

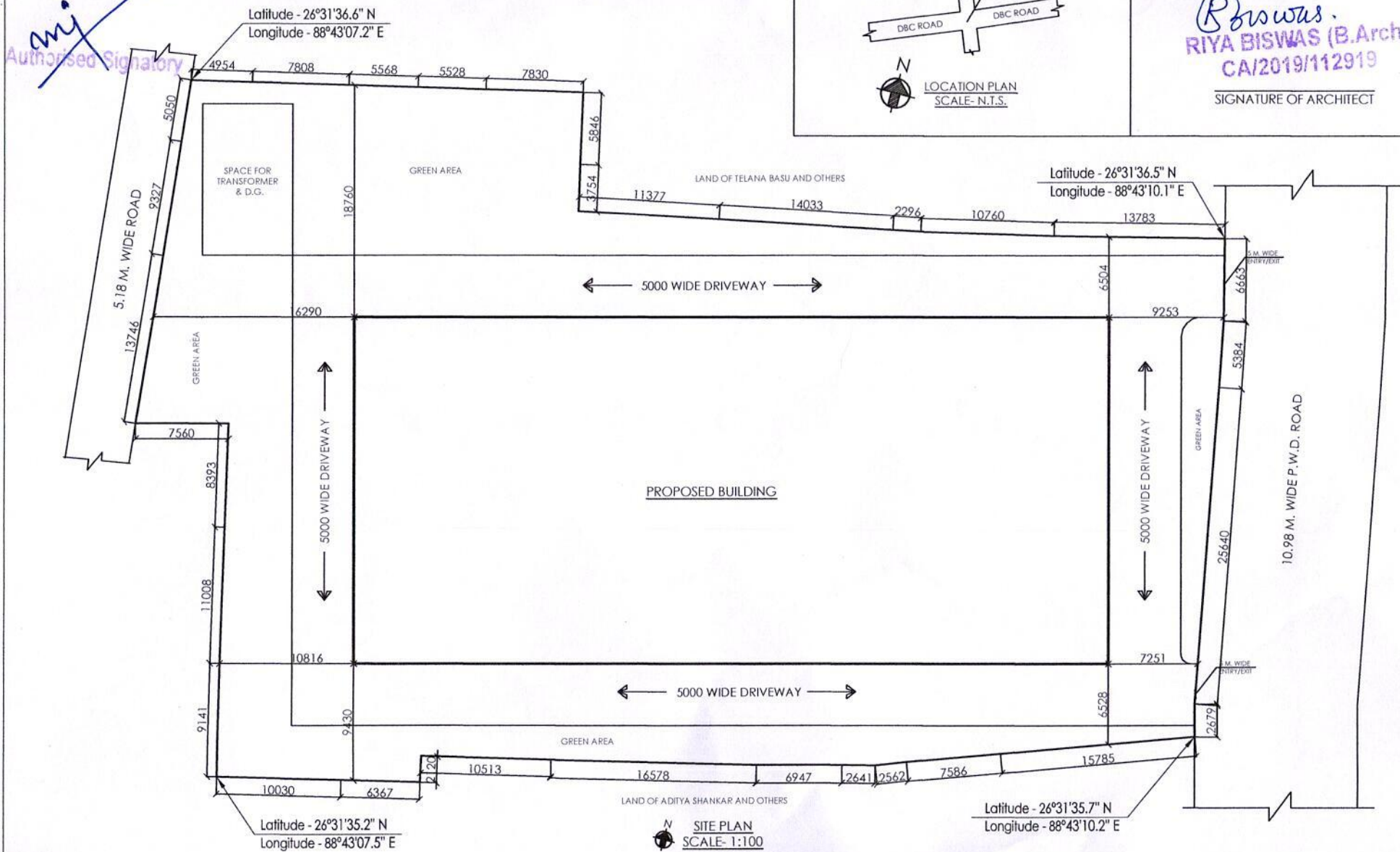

Kanchanjunga Builders LLP

*mi*  
Authorised Signatory